

AQUALUC S:OLID RGBW

- fully encapsulated rigid LED light line with thermal conductive polyurethane-ceramic compound and IP 68* protection
- for underwater installations up to a depth of 1.2 m (immersion time < 2 years, 1 ppm free chlorine at 35 °C, ptt value of 6.8-7.6)
- protected by hard encapsulation against mechanical, physical and chemical influences
- resistant to water and UV radiation
- uniform, absolute homogeneous illumination over the entire light emitting surface
- as opposed to metal, no occurrence of oxidation (rust) as completely made of plastic
- current limiter and high amount of copper in FPC enable a long lifetime

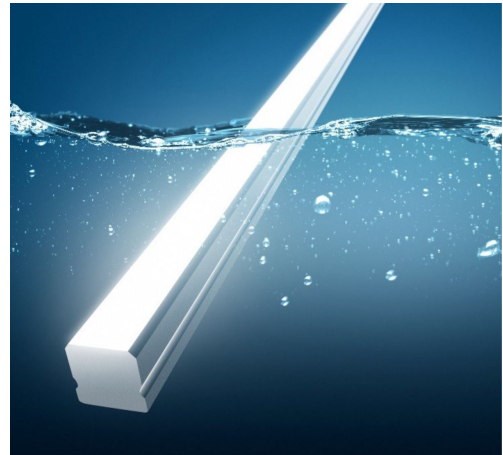

Please observe the installation and safety instructions at <https://www.barthelme.de/content/en/manuals.aspx> !

When ordering, please note the article number scheme at the end of the data sheet.

PHOTOMETRIC DATA



AQUA-5003-RGBW	
Type of color	RGBW
Typ. color temperature	3000 K
Light color	RGBW
Typ. total luminous flux per metre	492 lm/m
Typ. luminous flux per metre red	83 lm/m
Typ. luminous flux per metre green	170 lm/m
Typ. luminous flux per metre blue	35 lm/m
Typ. luminous flux per metre white	204 lm/m
Efficiency	30 lm/W
Beam angle	120 °
Dimming	dimmable
LED strip used	LEDlight flex 12 10 RGBW
L70 bei Ta < 35°C	>30000 h

PHOTOMETRIC DATA TOLERANCES IN THE AQUALUC FAMILY: The stated photometric data of the AQUALUC products are typical values which in practice are influenced by the binning of the LED's as well as the individual production steps in the encapsulation process. Factors such as layer thickness, type of encapsulation and the light color of the uncoated LED's have an influence on the resulting color temperature of the finished AQUALUC product. As each of these factors are subject to process and production related tolerances the resulting photometric data of the AQUALUC products can deviate from the stated typical values.

ELECTRICAL DATA

AQUA-5003-RGBW	
Operating voltage	24 V DC
Power per meter	16,3 W/m

MECHANICAL DATA

	AQUA-5003-RGBW
Width	17,5 mm
Height	17,5 mm
Type of protection	IP 68

Aqualuc products have a length tolerance +/- 5 mm at < 1 m and +/- 0.2 % at > 1 m

GENERAL DATA

	AQUA-5003-RGBW
Ambient temperature Ta	-20 °C ~ +35 °C
Max. temperature Tc	71 °C
Max. operable length	2680 mm
Max. buildable length with 1 m cable	2680 mm
Remarks	Connection/forwarding cable: optionally 1 - 6 m with free wire ends

ACCESSORIES

	40100141	40100142
Description	AQUALUC S:OLID support profile, PC plastic, UV resistant	
Material	polycarbonate	
Length	1000 mm	2000 mm
Width	21,6 mm	
Height	13,5 mm	
Remarks	When the AQUALUC S:OLID is inserted, the holding profile expands to a dimension of up to 22.5 mm.	

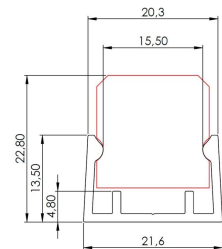

	30033019	63500024	63500033
Description	heat resistant double-sided tape, with excellent adhesive properties	Technical Vaseline, high purity, chemically neutral, 80 g tube, suitable for all mounting profiles	Silicone adhesive and sealant, one-component, transparent, cartridge 310 ml
Material	Acryl	various	
Length	33000 mm		
Width	9 mm		
Height	0,4 mm		
Remarks	33 m x 9 mm	For the assembly of the AQUALUC absolutely recommended	not suitable for PC-plastic profiles



The AQUALUC S:OLID light line is walkable - however, it must be ensured that no plastic support profile is used, as the plastic support profile cannot be walked on. A flat installation of the light line with the floor is possible. However, to protect the light-emitting surface, a downward offset installation of approx. 1-2mm is recommended.

ARTICLE NUMBER SCHEME

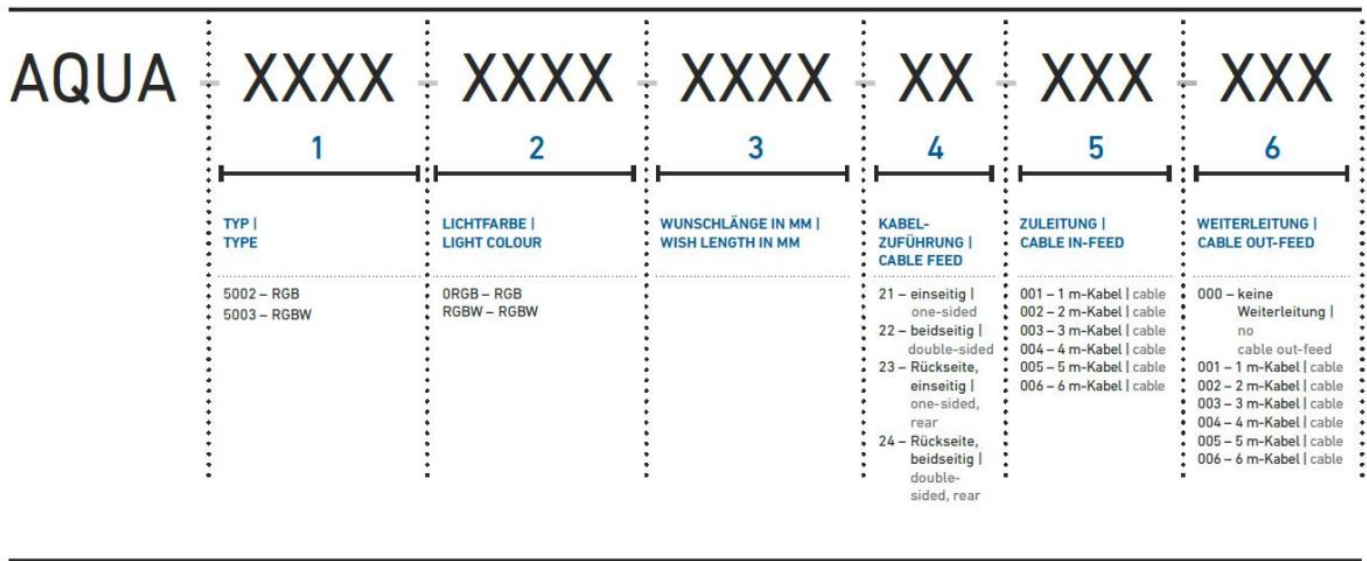

IN INDIVIDUELLEN LÄNGEN UND MIT BEIDSEITIGER EINSPEISUNG ERHÄLTlich | AVAILABLE IN INDIVIDUAL LENGTHS AND DUAL-SIDED FEED-IN

NOTE

During the production of encapsulated luminaires, air bubbles may be enclosed in the material. These bubbles are production-related and do not constitute a defect. If the bubbles are within the beam path of an LED, this can constitute a defect.

NOTE CHEMICALS

The AQUALUC encapsulation materials have successfully passed various test series in which resistance to salt, water, UV radiation, abrasion, dust and chemicals were tested. Each AQUALUC light line is ideally suited for indoor and outdoor illumination. For example on facades and bridges, in wellness oases and swimming pools, from maritime areas to industrial applications and vehicle technology - AQUALUC is already being used successfully everywhere. Despite the use of high quality materials and a robust design, there are chemical-related limitations in the areas of application. Please refer to the following link:

<https://www.barthelme.de/shared/download/katalog/AQUALUC-Chemische-Mittel-Chemical-Agents.pdf>

The guarantee period for the product is 5 years and begins on the day of shipment. Reference is the date of the delivery bill. The guarantee period may differ for accessories.